

SECTION VIEW



EXISTING STRUCTURE

- CONSTRUCTION NOTES:
- 1) ALL WELDS SHALL BE CONTINUOUS X 1/4" UNLESS OTHERWISE NOTED.
 - 2) WELD ALL CONTACT STEEL EDGES.
 - 3) ALL STRUCTURAL STEEL SHALL BE PRIMED AND PAINTED AS OUTLINED IN THE SPECIFICATIONS.
 - 4) ALL STRUCTURAL STEEL SHALL BE ASTM A-36 STRUCTURAL STEEL.

NOTE: REMOVE EXISTING FISH BARRIER STRUCTURE AND DISPOSE OFF-SITE (APPROX. 60 FOOT LENGTH)

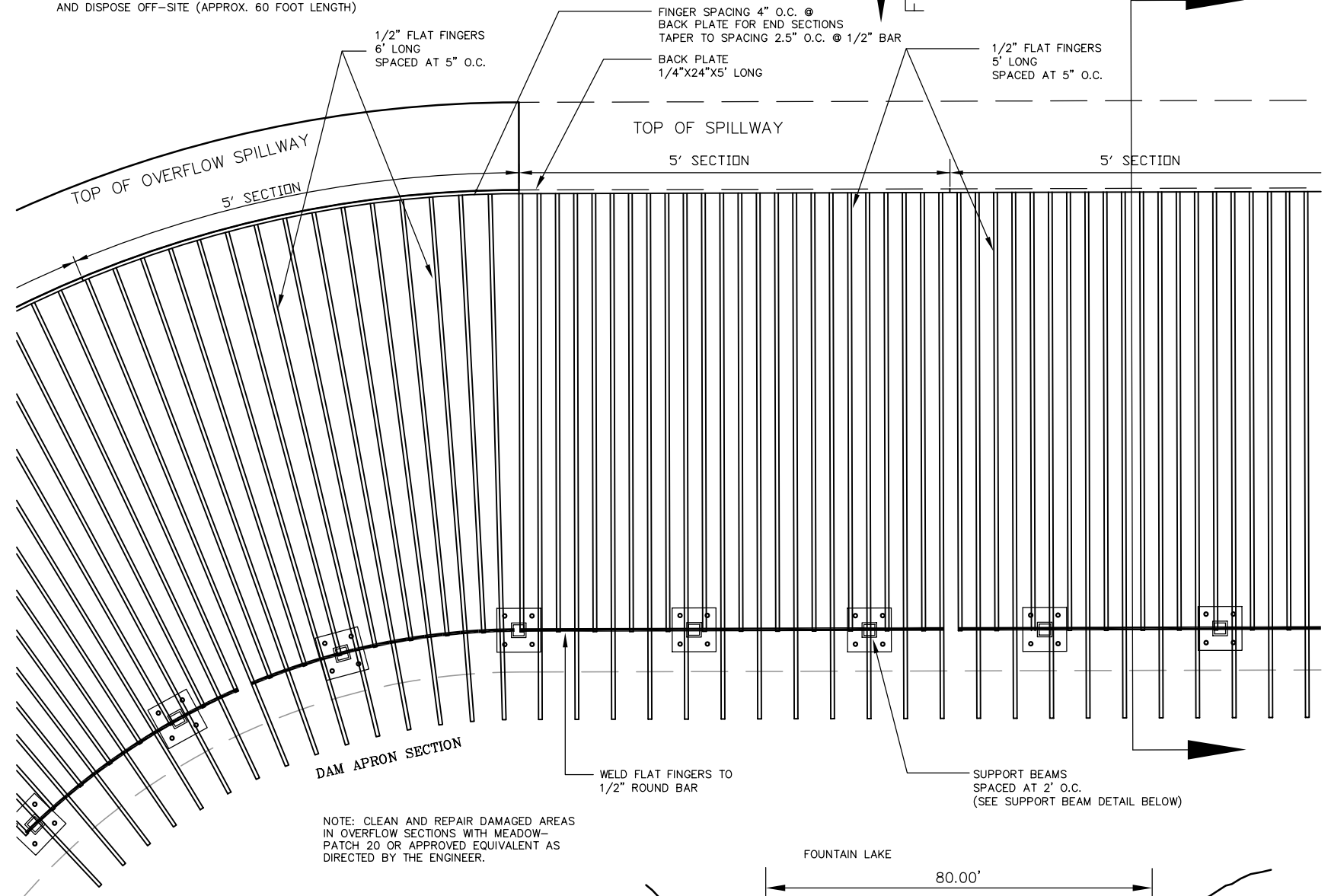

PLAN VIEW

NOTE: CLEAN AND REPAIR DAMAGED AREAS IN OVERFLOW SECTIONS WITH MEADOW-PATCH 20 OR APPROVED EQUIVALENT AS DIRECTED BY THE ENGINEER.

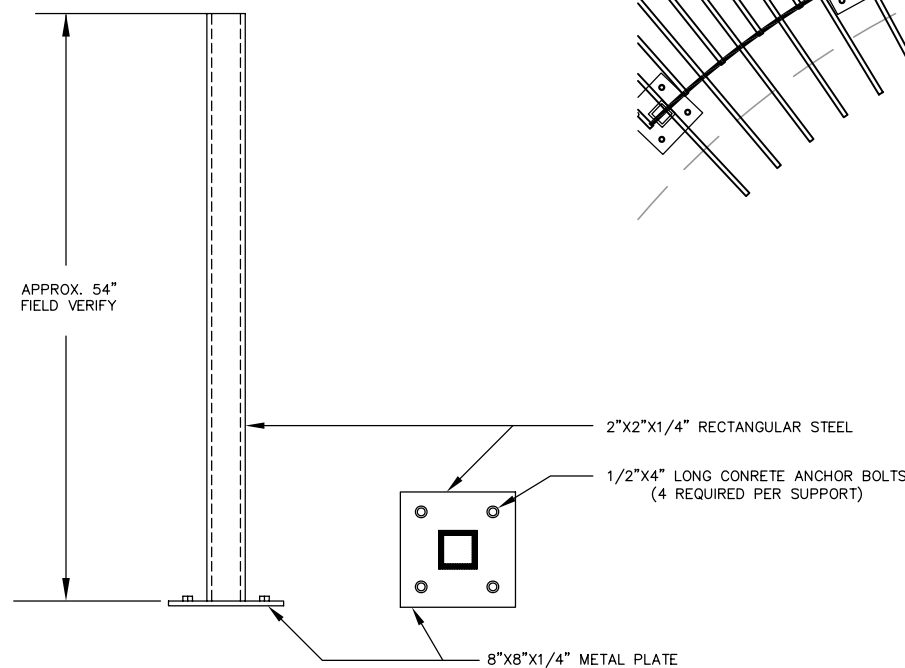

SUPPORT BEAM DETAIL

37 BEAMS REQUIRED

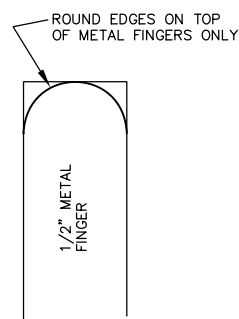

FABRICATION DETAIL

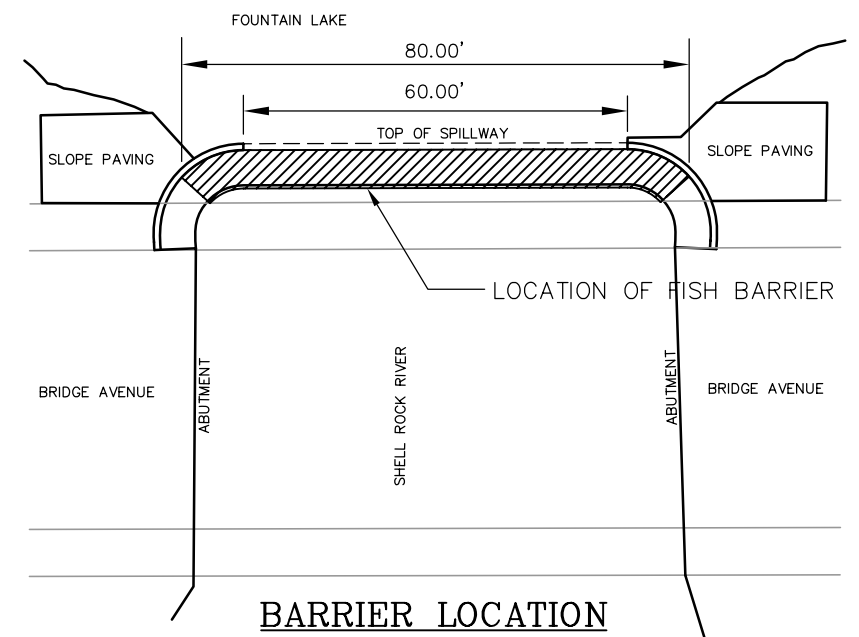

BARRIER LOCATION

I HEREBY CERTIFY THAT THIS PLAN, SPECIFICATION, OR REPORT WAS PREPARED BY ME OR UNDER MY DIRECT SUPERVISION AND THAT I AM A DULY LICENSED PROFESSIONAL ENGINEER UNDER THE LAWS OF THE STATE OF MINNESOTA.

GGG
GEOFFREY G. GRIFFIN
DATE 7/8/09 REG. NO. 21940

DATE: 07-06-09
Prepared For:
SHELL ROCK RIVER
WATERSHED DISTRICT
411 S BROADWAY PO BOX 1147
ALBERT LEA, MN 56007
FILE NO.: 04-024 CP.dwg

G³
G-Cubed
14070 Hwy 52 S.E.
Chatfield, MN 55923

ENGINEERING
SURVEYING
PLANNING
Ph. 507-867-1666
Fax 507-867-1665
www.ggg.to

DESIGNED GGG
DRAWN MLB
CHECKED GGG

REVISED	BY	DATE
CEMENTITIOUS PATCH	MLB	7.6.09

CITY OF ALBERT LEA
2009 CONSTRUCTION

MECHANICAL FISH BARRIER
FOUNTAIN LAKE FISH BARRIER

NOT TO SCALE

SHEET 1
OF 1 SHEETS